



Cast steel oval body gate valves outside screw and yoke, PN 25



Art. 63

Flanges: UNI EN 1092-2 PN 25

Design: DIN 3352 Face to face length: EN 558-1, serie 15. DIN 3202 F5

Installation: horizontal/ vertical

APPLICATIONS • Water • Steam • Oil and refineries

The cast steel oval body gate valves outside screw and yoke are used for several installations, usually for industrial plants with dangerous liquids, or high temperature, and they can carry pressure up to 25 bar. This gate valve is flanged PN 25. These gate valves are made in cast steel, with body and wedge seat rings in stainless steel. They come from standard execution by handwheel.

Materials

body-bonnet	cast steel GS-C25, GP-240-GH
wedge	cast steel GS-C25, GP-240-GH
handwheel	pressed steel
stem	stainless steel X20 CR13
sealing seats body and wedge	stainless steel
stem packing	graphite
bonnet gasket	graphite
painting	nitro enamel outside

Dimensions

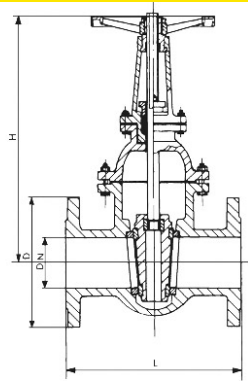

DN	L mm.	H mm.	D mm.	Weight kg.
40	240	357	150	20
50	250	387	165	21
65	270	463	185	26
80	280	520	200	35
100	300	604	235	50
125	325	720	270	65
150	350	827	300	94
200	400	1035	360	183
250	450	1233	425	229
300	500	1435	485	373
350	550	1650	555	509
400	600	1845	620	727
450	650	2100	670	1080
500	700	2330	730	1140
600	800	2745	845	1758

Pressure

DN	Nominal pressure	Test pressure Mpa	Max working pressure Mpa
mm	BAR	body	seat
150°C	400°C		
40-600	25	4,0	2,75
		2,14	1,44

