



## Cast steel oval body gate valves outside screw and yoke, PN 16



Art. 62

Flange: UNI EN 1092-2 PN 16

Design: DIN 3352 Face to face length: EN 558-1, serie 15. DIN 3202 F5

Installation: horizontal/ vertical

APPLICATIONS • Water • Steam • Oil and refineries

The cast steel oval body gate valves outside screw and yoke are used for several installations, usually for industrial plants with dangerous liquids, or high temperature, and they can carry pressure up to 16 bar. This gate valve is flanged PN 16. These gate valves are made in cast steel, with body and wedge seat rings in stainless steel. They come from standard execution by handwheel, DN 600 gear operated.

### Materials

body-bonnet	cast steel GS-C25, GP-240-GH
wedge	cast steel GS-C25, GP-240-GH
handwheel	pressed steel
stem	stainless steel X20 CR13
sealing seats body and wedge	stainless steel
stem packing	graphite
bonnet gasket	graphite
painting	nitro enamel outside

## Dimensions

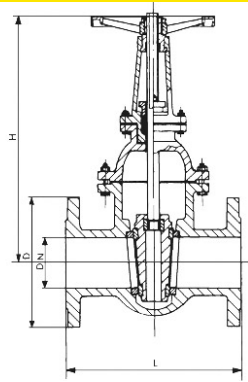

DN	L mm.	H mm.	D mm.	Weight kg.
40	240	380	150	20
50	250	426	165	22
65	270	520	185	26
80	280	555	200	32
100	300	644	220	46
125	325	746	250	62
150	350	845	285	83
200	400	1045	340	134
250	450	1245	405	210
300	500	1450	460	339
350	550	1580	520	420
400	600	1810	580	495
450	650	2000	640	600
500	700	2200	715	900
600	800	2600	840	1100

## Pressure

DN	Nominal pressure	Test pressure Mpa	Max working pressure Mpa
mm	BAR	body	seat
150°C	400°C		
40-600	16	2,4	1,76
		13,7	0,9

