



Cast steel cylindrical body gate valves outside screw and yoke, PN 100



Art. 3258

Flanges: UNI EN 1092-2 PN 100

Design: DIN 3352 Face to face length: EN 558-1, serie 26. DIN 3202 F7

Installation: horizontal/ vertical

APPLICATIONS • Water • Steam • Oil and refineries

The cast steel cylindrical body gate valves outside screw and yoke are used for several installations, usually for industrial plants with dangerous liquids, or high temperature, and they can carry pressure up to 100 bar. This gate valve is flanged PN 100. These gate valves are made in cast steel, with body and wedge seat rings in stainless steel. They come from standard execution by handwheel.

Materials

body-bonnet	cast steel GS-C25, GP-240-GH
wedge	cast steel GS-C25, GP-240-GH
handwheel	cast steel GS-C25, GP-240-GH
stem	stainless steel X20 CR13
sealing seats body and wedge	stainless steel
stem packing	graphite
bonnet gasket	graphite
painting	nitro enamel outside

Dimensions

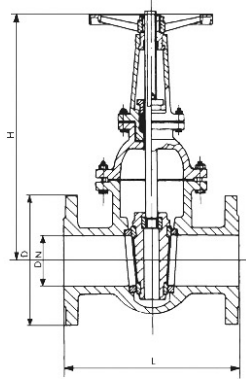

DN	L mm.	H mm.	D mm.	Weight kg.
50	250	410	195	48
65	290	520	220	70
80	310	530	230	90
100	350	600	265	125
125	400	720	315	150
150	450	770	355	210
200	550	920	430	370
250	650	1170	505	550
300	750	1260	585	780
350	850	1450	655	1000
400	950	1600	715	1350

Pressure

DN	Nominal pressure	Test pressure Mpa	Max working pressure Mpa		
mm	BAR	body	seat	150°C	400°C
50-400	100	15,0	11,0	8,56	5,78

