



Cast steel cylindrical body gate valves outside screw and yoke, PN 63



Art. 2958

Flanges: UNI EN 1092-2 PN 63

Design: DIN 3352 Face to face length: EN 558-1, serie 26. DIN 3202 F7

Installation: horizontal/ vertical

APPLICATIONS • Water • Steam • Oil and refineries

The cast steel cylindrical body gate valves outside screw and yoke are used for several installations, usually for industrial plants with dangerous liquids, or high temperature, and they can carry pressure up to 63 bar. This gate valve is flanged PN 63. These gate valves are made in cast steel, with body and wedge seat rings in stainless steel. They come from standard execution by handwheel.

Materials

body-bonnet	cast steel GS-C25, GP-240-GH
wedge	cast steel GS-C25, GP-240-GH
handwheel	cast steel GS-C25, GP-240-GH
stem	stainless steel X20 CR13
sealing seats body and wedge	stainless steel
stem packing	graphite
bonnet gasket	graphite
painting	nitro enamel outside

Dimensions

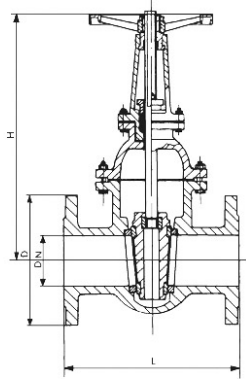

DN	L mm.	H mm.	D mm.	Weight kg.
50	250	410	180	45
65	290	520	205	65
80	310	53	215	80
100	350	600	250	100
125	400	720	295	135
150	450	770	345	180
200	550	920	415	300
250	650	1170	470	450
300	750	1260	530	650
350	850	1450	600	830
400	950	1600	670	1200

Pressure

DN	Nominal pressure	Test pressure Mpa	Max working pressure Mpa
mm	BAR	body seat	150°C 400°C
50-400	63	9,45 6,93	5,39 3,64

