



Cast steel "Y" strainer flanged RF ANSI class # 150



Art. 1801

Design & construction: API 600, API 6D  
 Face to face length: ASME / ANSI B16.10  
 Connections & dimensions: ASME / ANSI B16.5, ASME / ANSI B 16.25  
 Flanges: RF ANSI #150  
 Pressure & temperature: ASME / ANSI B16.34  
 Test: API 598

The "Y" strainers are suitable to retain and collect any impurity from the pipeline. The cast steel "Y" strainers are manufactured in cast steel A216WCB according to API, ANSI, ASME standard, for industrial applications. The basket screen made in stainless steel 304 or 316 is removable for its cleaning.

- Fig. 1801A: body st.st. CF8M, screen 316

**Materials**

|            |                                    |
|------------|------------------------------------|
| body-cover | cast steel A216WCB, GP240GH+N      |
| screen     | stainless steel AISI 304           |
| gasket     | graphite                           |
| drain plug | forged steel A105                  |
| bolts      | A 193 GR. B7                       |
| nuts       | A 194 GR 2H                        |
| painting   | high chlorinated polyethylene HCPE |

## Dimensions

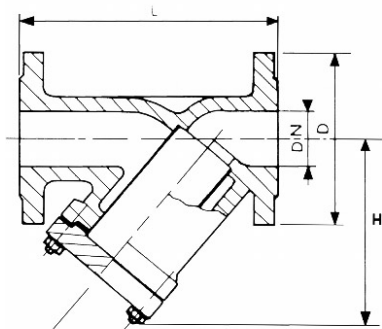

| DN  | L mm. | H mm. | D mm. | Weight kg. |
|-----|-------|-------|-------|------------|
| 2"  | 203   | 200   | 152   | 12         |
| 3"  | 241   | 260   | 190   | 28         |
| 4"  | 292   | 320   | 229   | 40         |
| 6"  | 406   | 370   | 279   | 87         |
| 8"  | 495   | 480   | 343   | 150        |
| 10" | 622   | 590   | 406   | 220        |
| 12" | 698   | 720   | 483   | 260        |

## Pressure

### Hydrostatic test

### Pneumatic test

| shell |      | seat |      | Pneumatic test |      |
|-------|------|------|------|----------------|------|
| bars  | psig | bars | psig | bars           | psig |
| 30    | 435  | 23   | 335  | 5,6            | 80   |

