



Metal seated oval body gate valves in cast iron outside screw and yoke, PN 10 and 16



Art. 12-18

Design: DIN 3352 Face to face length: EN 558-1, serie 15. DIN 3202 F5

Installation: horizontal/ vertical

APPLICATIONS • Industry • Fire fighting systems

- Fig. 12: flanges drilled UNI EN 1092-2 PN 10

- Fig. 18: flanges drilled UNI EN 1092-2 PN 16

The metal seated oval body gate valves in cast iron outside screw and yoke are a good solution for all those applications where it is necessary to check visually whether the valve is open or closed. With oval body, rising stem, they are widely used in industrial plants. These gate valves are suitable to carry pressure up to 16 bar. They come from standard execution by handwheel.

Materials

body - bonnet	cast iron GG25, EN-GJL-250
wedge	cast iron GG25, EN-GJL-250
handwheel	cast iron GG25, EN-GJL-250
stem	brass/ stainless steel X20 CR13
sealing seats body & wedge	brass
stem packing	graphited / o ring
bonnet gasket	asbestos free
painting	nitro enamel

Dimensions

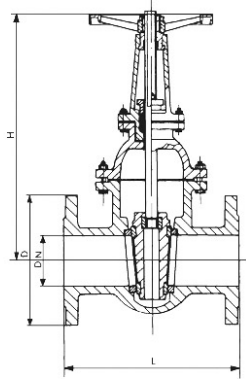

DN	L mm.	H mm.	D mm.	Weight kg.
40	240	265	150	15
50	250	275	165	20
65	270	335	185	26
80	280	380	200	31
100	300	435	220	40
125	325	495	250	65
150	350	585	285	83
200	400	710	340	116
250	450	830	395/405	177
300	500	1340	445/460	271
350	550	1580	505/520	355
400	600	1494	565/580	465
450	650	1615	615/640	675
500	700	1850	620/715	970
600	800	2140	780/840	1110

Pressure

DN	Nominal pressure	Test pressure Mpa	Max working pressure Mpa
mm	BAR	body	seat
120°C	150°C		
40-600 fig 12	10	1,5	1,1
40-600 fig 18	16	2,4	17,6
		1,4	0,8

